



National Trust *for*  
Historic Preservation®



## 2026 Coloring Book

Featuring National Trust Historic Sites and members and affiliates of the Historic Artists' Homes and Studios program.



# The Glass House

## New Canaan, Connecticut

The Glass House is a National Trust historic site and one of 14 structures on a 49-acre landscape developed between 1949 and 1995 by architect Philip Johnson. The house, which helped usher the International Style into American residential architecture, is recognized for its innovative use of materials and seamless integration into the landscape.

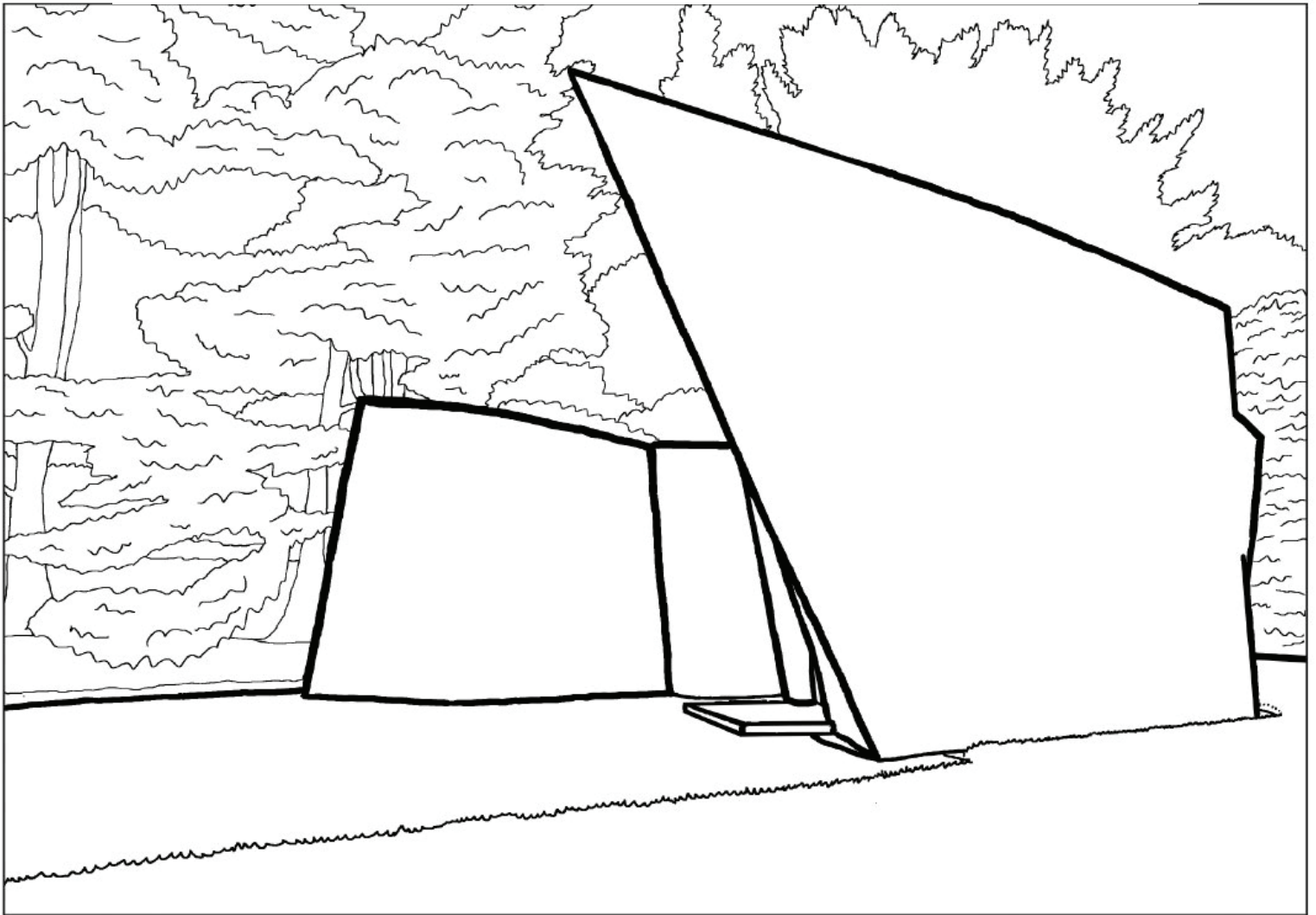

Da Monsta is one of 14 structures on the Glass House property. Image courtesy of the Glass House.



# Oatlands

## Leesburg, Virginia

Oatlands, a National Trust historic site, was built in 1804 as a plantation where enslaved people lived and labored. Today, the site encompasses 418 acres and 28 buildings dating to the 19th and 20th centuries. Through inclusive interpretation and education, Oatlands explores the evolving meaning of freedom and the many communities that have shaped its landscape over time.

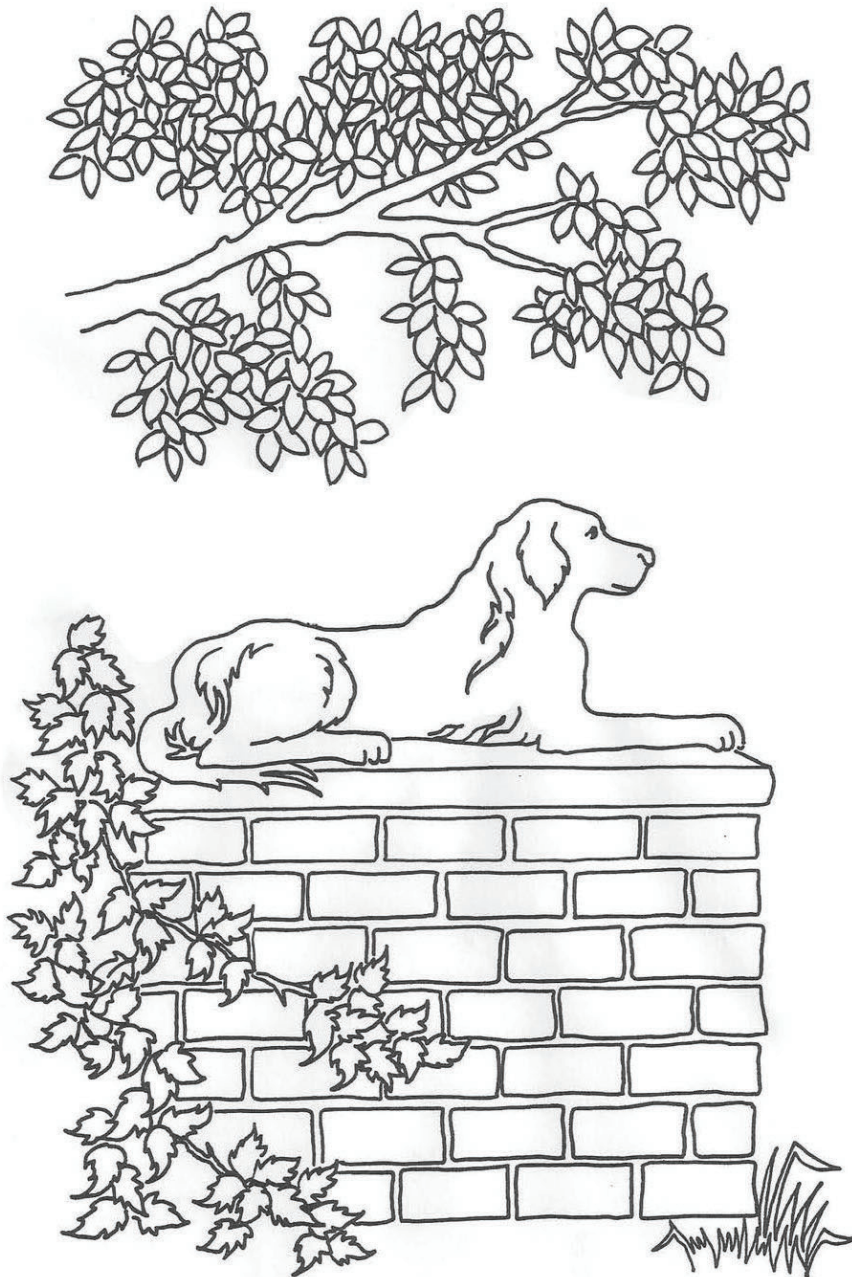

Rusty, a recently restored statue, stands in the Oatlands garden. Image courtesy of Oatlands.



# Kykuit

## Tarrytown, New York

Kykuit, a National Trust historic site, was built between 1908 and 1913 by architect William Welles Bosworth for businessman and philanthropist John D. Rockefeller. The Beaux-Arts house and elaborate formal gardens were home to four generations of the Rockefeller family. Today, the site offers public tours, lectures, cultural events, and artist residencies.



A print of the Temple of Aphrodite by architect William Welles Bosworth. Image courtesy of Rockefeller Brothers Fund.



# Edith Farnsworth House

## Plano, Illinois

Designed by architect Ludwig Mies van der Rohe, the Edith Farnsworth House was constructed between 1946 and 1951. It served as a weekend retreat for Dr. Edith Farnsworth, a prominent Chicago-based nephrologist. The house, now a National Trust historic site, is considered a masterpiece of the International Style of architecture and opened to the public in 2004.

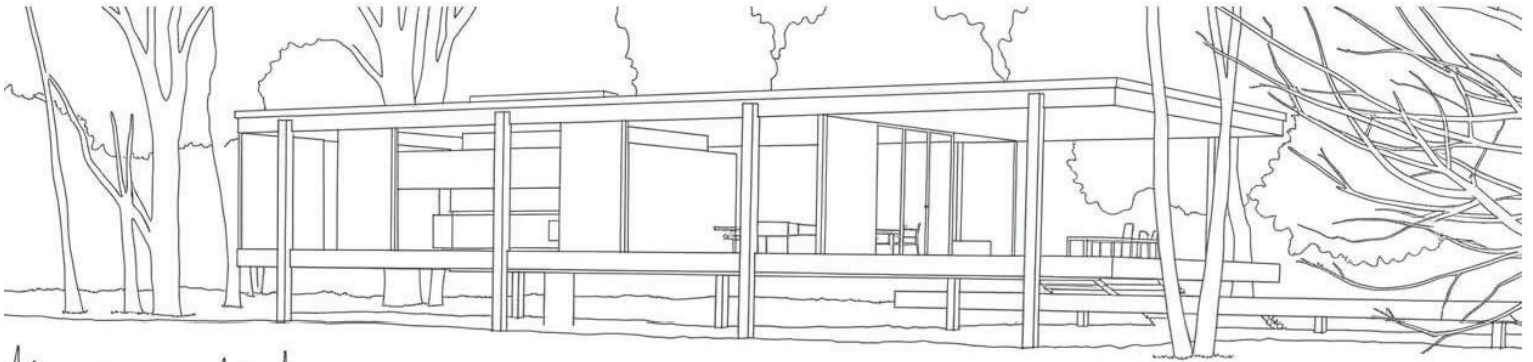

Daffodils grow on the grounds of the Edith Farnsworth House. Image courtesy of the Edith Farnsworth House.



# Wharton Esherick Museum

## Malvern, Pennsylvania

The Wharton Esherick Museum is the home and studio of artist Wharton Esherick, who was a pioneer of the American studio furniture movement. Today, the museum campus is composed of multiple buildings, including Esherick's hand-built studio and Expressionist garage. The site is a founding member of the National Trust's Historic Artists' Home and Studios program.



This woodcut was created by Esherick for his wife Letty, who grew and sold peonies and needed an image for her price list. Image courtesy of the Wharton Esherick Museum.



# Spiral House Park

## Saugerties, New York

Spiral House Park spans 45 acres in New York's Catskill Mountains and was the home of artist Tom Gottsleben and his wife, Patty Livingston. The park includes the five-story Spiral House, Gottsleben's large sculptures (including Rainbow Portal, which is composed of twelve archways crafted from bluestone and crystal glass), as well as pollinator gardens and woodland trails.

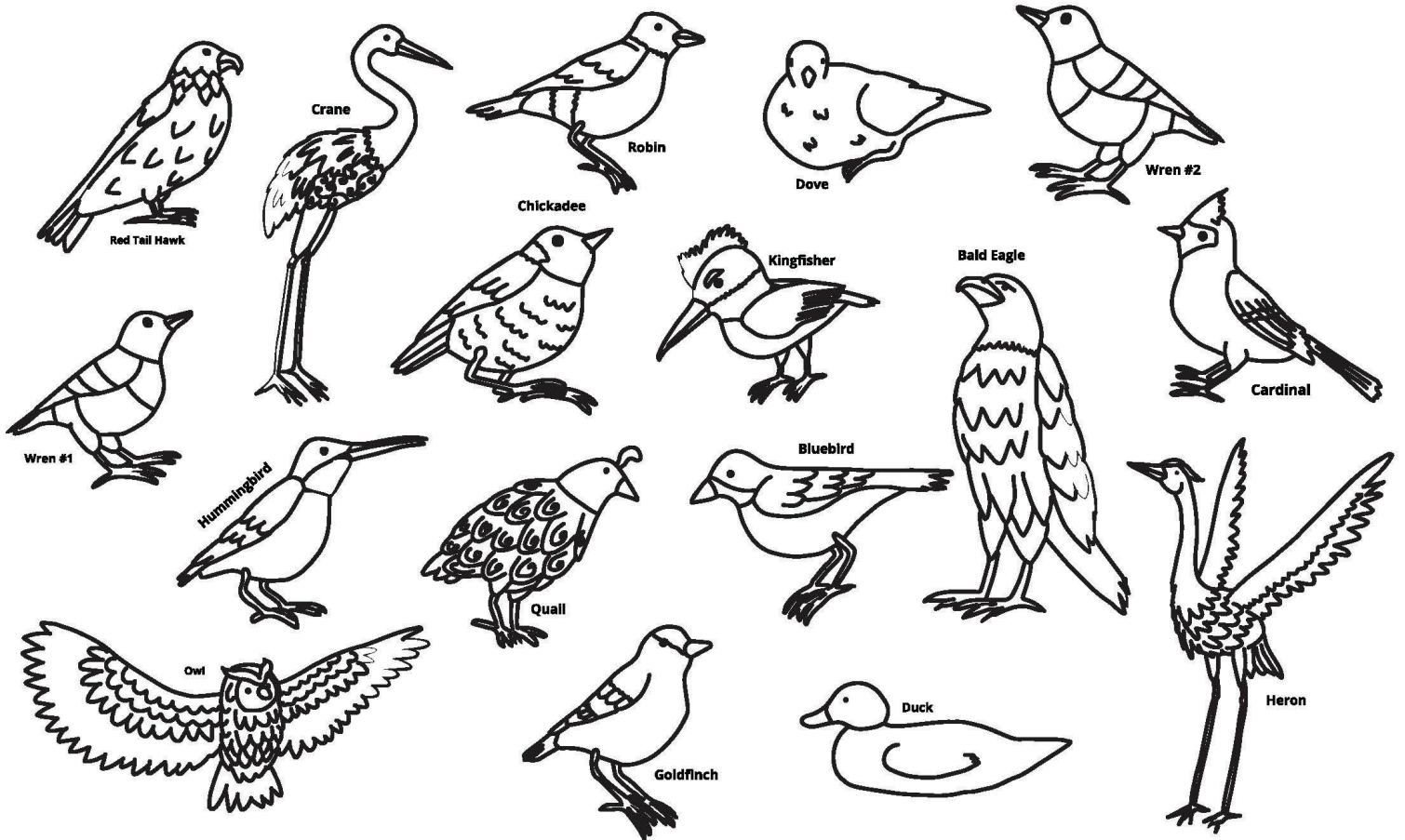

Seventeen metal birds are hidden along Spiral House Park's Sculpture Trail for visitors to find. Image designed by Aglaia Kilb and courtesy of Spiral House Park.



# Albin Polasek Museum & Sculpture Gardens

## Winter Park, Florida

Founded in 1961, the Polasek Museum was once the home and studio of sculptor and painter Albin Polasek. Born in 1879 in Frenštát pod Radhoštěm, in what is now the Czech Republic, Polasek immigrated to the United States in 1901 and had a long career in the arts. Today, the museum campus includes Polasek's former Mediterranean-style home, a gallery, chapel, and sculpture garden.



The butterfly fountain at the Polasek Museum. Image courtesy of the Albin Polasek Museum & Sculpture Gardens.



# Demuth Museum

## Lancaster, Pennsylvania

Established in 1981, the Demuth Museum is the former home and studio of painter Charles Demuth. A modernist and master watercolorist, Demuth was a leading figure in the Precisionist art movement. Today, the museum features his work alongside exhibitions, educational programs, and a historic garden.



Charles Demuth in the garden he shared with his mother, Augusta. Image courtesy of the Demuth Museum.



National Trust *for*  
Historic Preservation®

# Bush-Holley House, Greenwich Historical Society

## Cos Cob, Connecticut

The Bush-Holley House reflects the history of two families: the Bush family, who built the house, and the Holley family, who ran it as a boardinghouse that hosted the Cos Cob Art Colony. Today, the site houses a collection of works by members of the art colony. In addition to its art collection, it includes a library, archives, and gardens.



The historic flower gardens at Bush-Holley House, Greenwich Historical Society. Image courtesy of the Greenwich Historical Society.



National Trust *for*  
Historic Preservation®

# Weir Farm National Historical Park

## Wilton, Connecticut

Between 1882 and 1919, Weir Farm was the summer home of artist Julian Alden Weir. An Impressionist painter, Weir used the farm's open landscape to paint en plein air. Today, the farm, a member of the Historic Artists' Home and Studios program and a national park, is the only park dedicated to American painting.

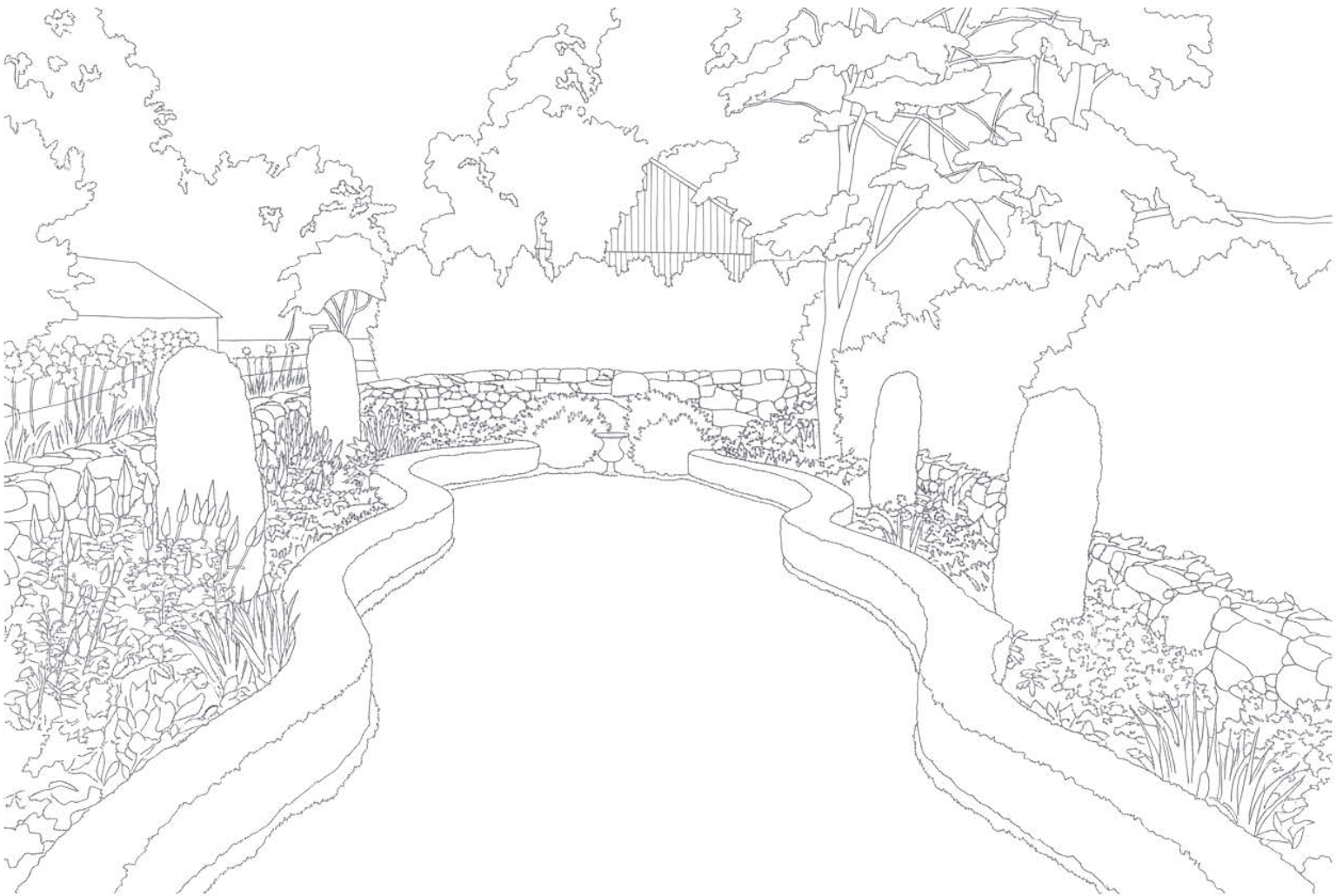

The Sunken Garden at Weir Farm National Historical Park. Image courtesy of Weir Farm National Historical Park.



National Trust for  
Historic Preservation®

# Soldner Center for the Arts and Innovation

## Aspen, Colorado

Originally the home of painter and poet Ginny Soldner and ceramicist Paul Soldner, the Soldner Center for the Arts and Innovation is today a museum and cultural center. The five-acre campus includes five historic buildings, including the Soldners' former home, which they designed and hand-built.



Oriental poppies, one of artist Ginny Soldner's favorite flowers, grow on the grounds of the Soldner Center for the Arts and Innovation. Image courtesy of the Soldner Center for the Arts and Innovation.



National Trust *for*  
Historic Preservation®

# Saint-Gaudens National Historical Park

## Cornish, New Hampshire

Formerly the property of sculptor Augustus Saint-Gaudens, Saint-Gaudens National Historical Park was once the unofficial hub of the Cornish Colony, a group of prominent artists who spent the summer months together. Today, the site includes the family home Aspet, studios, galleries, gardens, and the longest-running artist residency in the National Park Service.



The path beside the white brick façade of Aspet shows spring flower beds in bloom and a shade tree anchoring the lawn. Image based on a photograph by Rob Strong, and courtesy of Saint-Gaudens National Historical Park.



# Couse-Sharp Historic Site

## Taos, New Mexico

The Couse-Sharp Historic Site includes the former homes and studios of painters Eanger Irving Couse and Joseph Henry Sharp and their families. While both artists focused on Indigenous subjects, Sharp also painted landscapes and nature. Today, the site features the artists' homes and studios, Couse's personal art collection, and seasonal exhibitions.



Hollyhocks, Virginia creeper, cosmos, and poppy plants grow at the Couse-Sharp Historic Site. Image courtesy of Couse-Sharp Historic Site.



# Olive Rush Historic Artist Home & Garden

## Santa Fe, New Mexico

Formerly the home of painter and muralist Olive Rush, the Olive Rush Historic Artist Home & Garden maintains a large collection of her work and archives. An advocate for Indigenous art education, Rush dedicated her career to painting and teaching. In addition to its museum and gardens, the site offers public art classes and events.



In 1930, Rush converted a goat shed into a guesthouse, which is surrounded by flower beds and a crabapple tree. Image courtesy of Olive Rush Historic Artist Home & Garden.

The National Trust for Historic Preservation is a privately funded nonprofit organization dedicated to helping communities maintain and enhance the power of historic places. Chartered by Congress in 1949 and supported by partners, friends, and champions nationwide, we help preserve the places and stories that make communities unique. Through the stewardship and revitalization of historic sites, we help communities foster economic growth, create healthier environments, and build a stronger, shared sense of civic duty and belonging.



**National Trust *for***  
**Historic Preservation®**

600 14th Street NW Suite 500  
Washington, DC 20005

[SavingPlaces.org](http://SavingPlaces.org)